

1.0 Bobbin winder assembly

1. Remove the bobbin winder from packaging and confirm that all components are present.

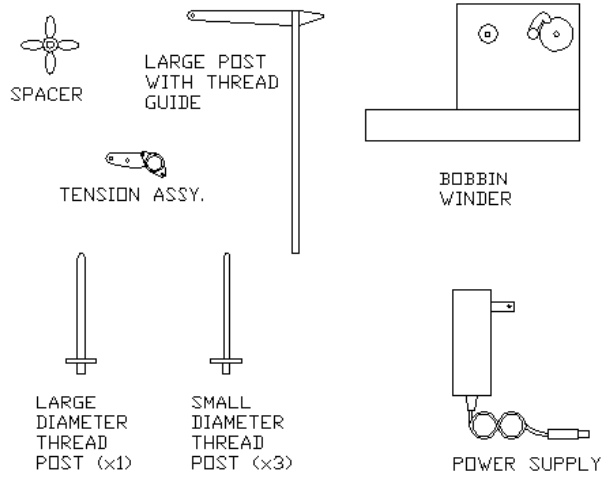

2. Install the large post into bobbin winder.

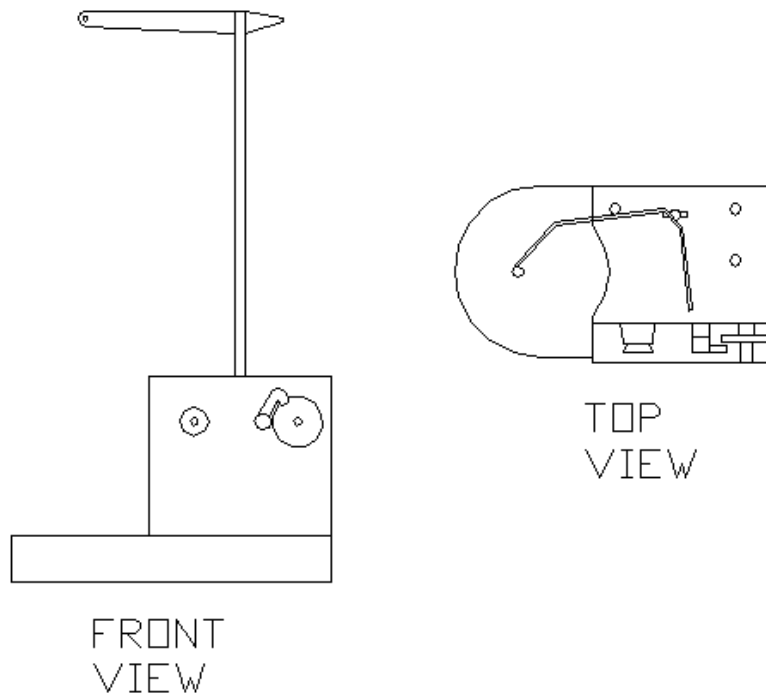

3. Install the tension assembly onto the large post using the supplied (2) screws. See illustrations below for correct tension assembly orientation.

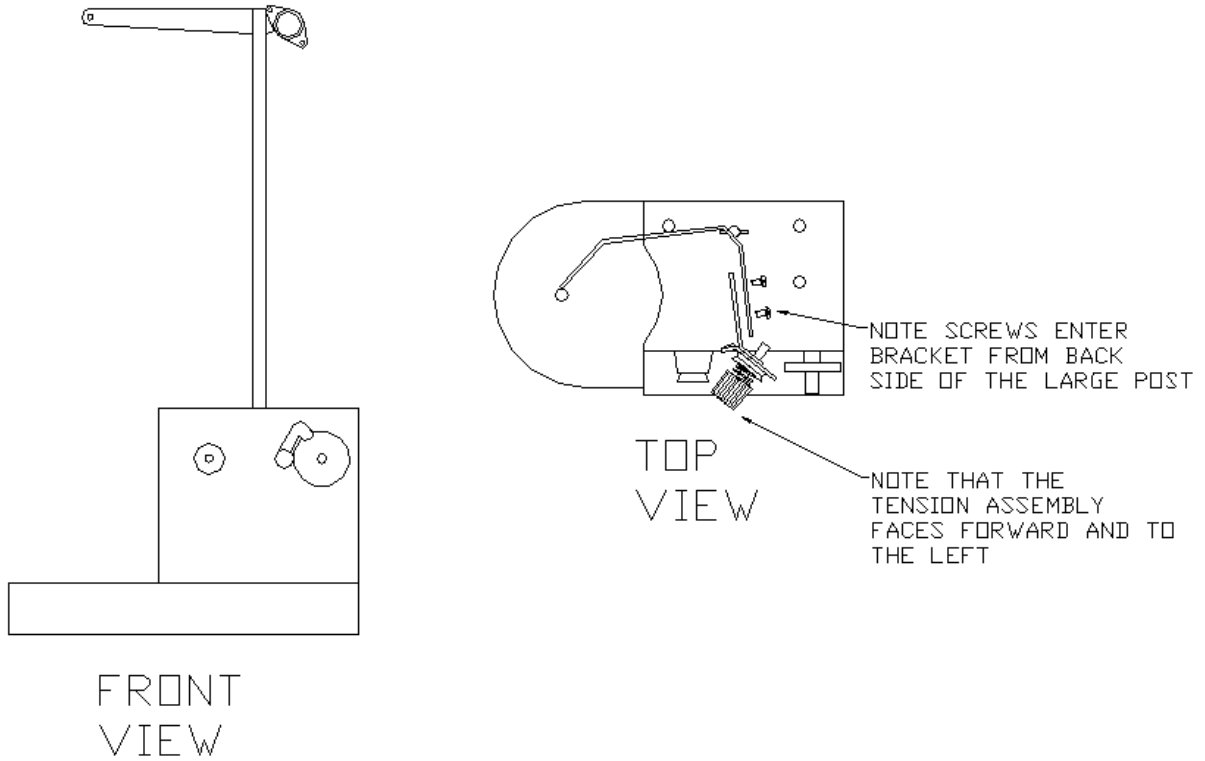

4. Install the (3) small diameter thread posts into the top of the bobbin winder.

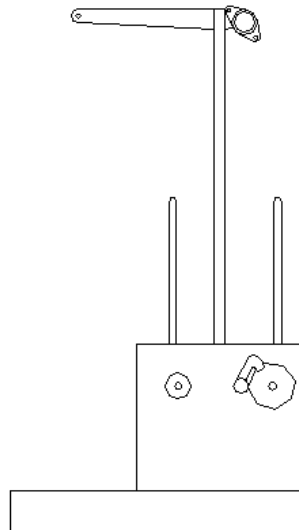

5. Install the large diameter thread post into the lower hole of the bobbin winder and install the spacer onto the post.

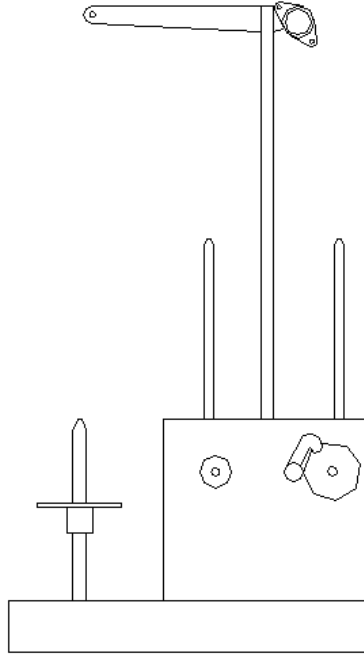

2.0 Threading the bobbin winder

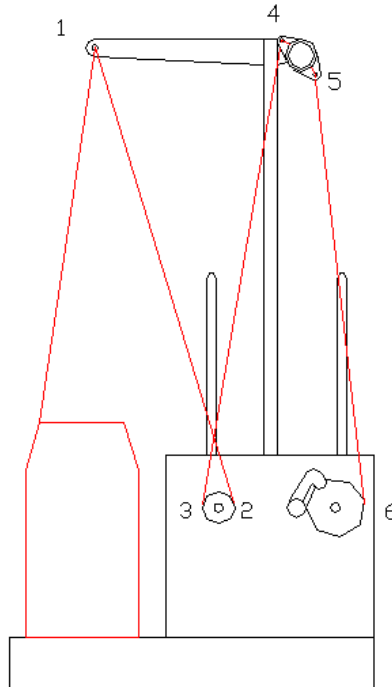

1. Pull slack from cone up to #1 and pass the thread from the back side to the front side through the small guide on the end of the large post.
2. Pass the thread from the small guide, #1, to the right side of the spring loaded pre-tension #2 below. Bring the thread clockwise under the bottom side of the pre-tension to #3. **DO NOT WRAP THE THREAD COMPLETELY AROUND THE PRE-TENSION.**
3. From the spring loaded pre-tension #3 pull the thread up to the back side of the upper tension assembly guide #4 and pass the thread through thread eyelet.
4. From the upper eyelet #4, pass the thread clockwise through the spring loaded tension disks and into the lower thread eyelet of the tension assembly #5. **DO NOT WRAP THE THREAD COMPLETELY AROUND THE TENSION.**
5. Wrap the thread clockwise around the bobbin shell.

3.0 Operating the bobbin winder

SET THE TENSION KNOB 5 COMPLETE CLOCKWISE TURNS FROM THE END OF THE THREAD TENSION ASSEMBLY POST.

1. Thread the winder as discussed in section 2.0
2. Install a bobbin case onto the motor shaft of the bobbin winder.
3. Wrap the thread clockwise around the bobbin 4 to 5 times leaving as small a tail as possible.

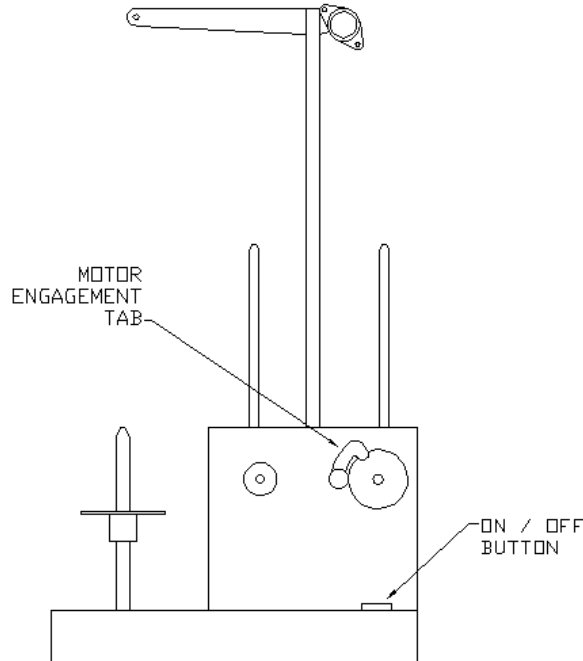

4. Depress motor engagement tab towards bobbin installed on motor shaft - it will click when engaged.
5. Press the ON/OFF button.
6. Bobbin winder motor turns OFF when motor engagement tab is reset by the thread on the bobbin or when the user presses the ON/OFF button.